

NOTE: STARTING IN 2002, PARCEL NUMBERS WILL NOT REFLECT THE TOWNSHIP ABBREVIATIONS, BUT THE 3-DIGIT TOWNSHIP NUMBER.

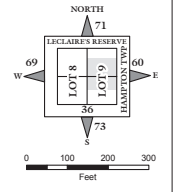

GIS DEPARTMENT  
ROCK ISLAND COUNTY,  
ILLINOIS

(A) MANUFACTURERS' ADD. TO EAST MOLINE - FILED MAY 1, 1923, IN PLAT BOOK 15, PAGE 29. 073278-3279

(B) NEW SHOPS ADD. TO EAST MOLINE - FILED OCT. 2, 1903, IN PLAT BOOK 8, PAGE 36. 073302-3310

SUPERVISORS' ASSESSMENT  
MAP OF  
PART OF LOT 9 LECLAIRE'S RESERVE,  
T. 18N., R. 1W. OF 4TH P.M., ALSO PART  
E 1/2 FRAC. SEC. 25, T. 18N., R. 1W.  
OF 4TH P.M.  
SOUTH MOLINE TOWNSHIP  
SUPPLEMENTAL FOR 2013  
THIS IS NOT A LEGAL DOCUMENT